

OFFSITE STORM FLOWPATH

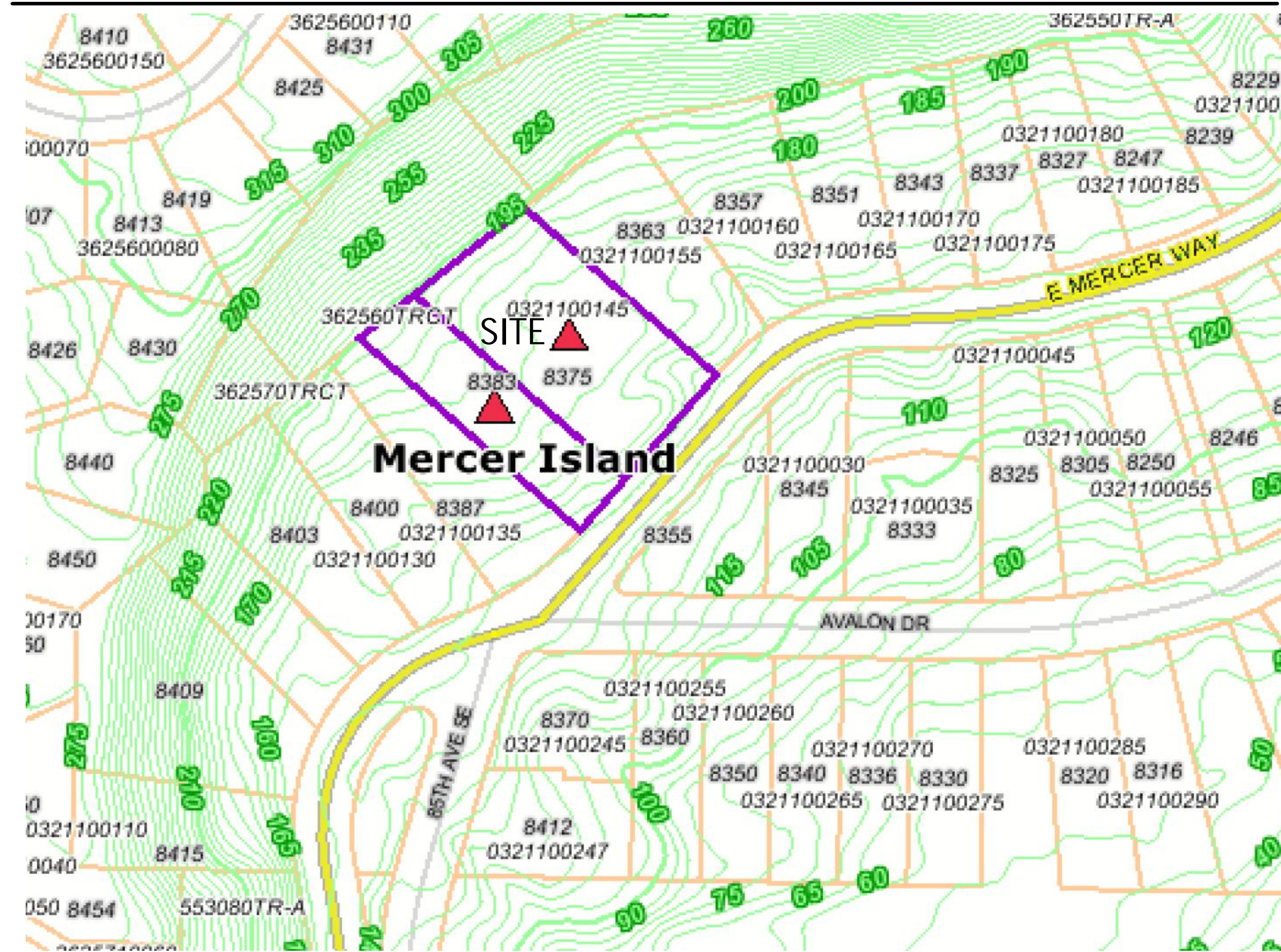

MAPPED GEOLOGIC HAZARD AREAS

-LANDSLIDE HAZARD  
PER CITY OF MERCER ISLAND GEOLOGIC HAZARDS MAP. SEE REPORT BY PANGEO FOR DISCUSSION AND MITIGATION RECOMMENDATIONS.

-SEISMIC HAZARD  
PER CITY OF MERCER ISLAND GEOLOGIC HAZARDS MAP. SEE REPORT BY PANGEO FOR DISCUSSION AND MITIGATION RECOMMENDATIONS.  
PERMANENT DEWATERING WELLS AND/OR AGGREGATE PIERS ARE RECOMMENDED TO STABILIZE.

WETLAND REPORT

-SEE STUDY BY THE WATERSHED CO., SEPT 9, 2014.

GEOTECHNICAL REPORT

-SEE PRELIMINARY GEOTECHNICAL STUDY BY PANGEO, SEPT 9, 2014.

DETENTION TYP.  
PREL SIZE SHOWN

DETENTION TYP.  
PREL SIZE SHOWN

ROCKERY TYP.  
MAX HEIGHT=5'

NEW WATER METERS

NEW FH

NEW 12" SD

EAST MERCER WAY

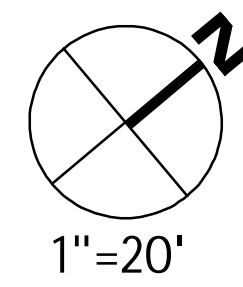

CATEGORY IV WETLAND "A"  
-29 POINTS  
-SEE REPORT BY THE WATERSHED CO.  
-BUFFER REDUCTION PROPOSED

PRIVATE SD ROOF SYSTEM

20' PRIVATE DRIVEWAY  
-20' WIDTH  
-MAX GRADE 20%  
-CURB ON ONE SIDE  
-SEE PREL PROFILE C3.1

DETENTION PIPE  
-PRELIMINARY SIZE & LOCATION

REGRADE STREET SLOPE

2693 GPM  
EX FH

NO.	DATE	BY	REVISIONS

APPLICANT  
RIPPLE DESIGN STUDIO, INC.  
JIM DEARTH  
4303 STONE WAY N  
SEATTLE, WA 98103  
206.913.2333

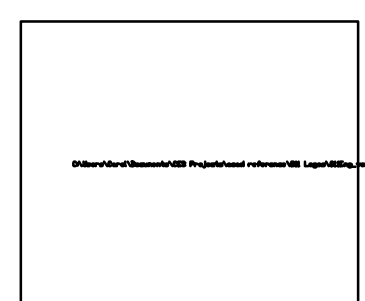

DATE: Jun 13, 2017  
JOB# 1337  
DRAFTED: CH DESIGN: DE  
DIGITAL SIGNATURE

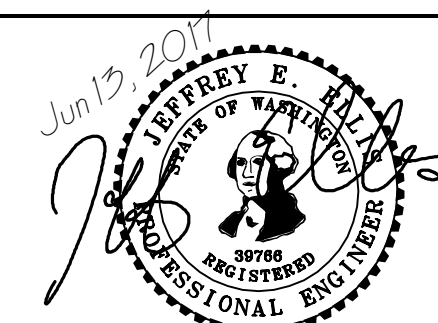

CIVIL ENGINEERING  
SOLUTIONS

2244 NW MARKET STREET, SUITE B SEATTLE, WA 98107  
PHONE: 206.930.0342 DUFFY@CESOLUTIONS.US

PRELIMINARY  
ENGINEERING PLAN  
RUN YONG USA, LLC - HAOLIN ZHENG  
8375 AND 8383 EAST MERCER WAY  
MERCER ISLAND, WA 98040

DRAWING NO:

C3.0

APN 032110-0145  
& 032110-0140